

Beatbot Sora P1

User Manual



Beatbot

LANGUAGE

EN	User Manual	1
FR	Manuel de l'utilisateur	16
ES	Manual de usuario	31
DE	Bedienungsanleitung	46
IT	Manuale d'uso	61

01/ Safety Regulations

⚠ IMPORTANT SAFETY INSTRUCTIONS **READ ALL INSTRUCTIONS BEFORE USING**

When installing and using this electrical equipment, always follow basic safety precautions, including the ones listed below:

WARNING: Carefully read all safety warnings and instructions. Failure to follow the warnings and instructions may result in electric shock, fire and/or serious injury.

1.1 Warnings and Cautions

READ AND FOLLOW ALL INSTRUCTIONS.

- This product can be used by children aged 8 years and older and by individuals with physical, sensory, intellectual deficiencies, or limited experience or knowledge under the supervision of a parent or guardian to ensure safe operation and to avoid any risks. Children should not perform cleaning or maintenance tasks without supervision.
- Children should not play with this product. Ensure children and pets are kept at a safe distance from the robot while it is operating.
- In order to prevent turning the robot on unintentionally. Ensure the robot is turned off before picking up or carrying it.
- Under abusive conditions, battery fluid may be expelled. Avoid contact. If contact occurs, rinse with water. If the fluid come in contacts with the eyes, immediately seek medical attention. Battery fluid may cause irritation or burns.
- Do not use a battery or appliance that is damaged or altered. Damaged or modified batteries may exhibit unpredictable behavior resulting in fire, explosion or risk of injury.
- Do not use any third-party battery or charger. Only use the specified Beatbot KLP072A-2802300zz supply unit. The suffix "zz"=BS, EU, CN, US, JP, AU, TW, IN, AR, BR or KR indicates the plug type for different regions. If the supply cord is damaged, it must be replaced by the manufacturer, its service agent or similarly qualified persons in order to avoid a hazard.
- To reduce the risk of electric shock, do not use an extension cord; instead, connect the unit directly to a properly located outlet and replace any damaged power cord immediately.
- Do not place the charger near heat sources. Follow all charging instructions and do not charge the appliance outside of the temperature range specified in the instructions. Charging improperly or at temperatures outside of the specified range may damage the battery and increase the risk of fire.
- Ensure the robot is powered off and the charger is unplugged before cleaning or performing maintenance.
- This product contains batteries that can only be replaced by qualified technicians. Do not modify or attempt to repair the appliance or the battery except as indicated in the instructions for use and care. Have servicing performed by a qualified repair person using only identical replacement parts. This will ensure that the product's safety is maintained.
- Do not enter pool while the robot is working in water.

- When the robotic pool cleaner is underwater or other situations where it is not convenient to lift the robot directly, it needs to be pulled out using the supplied hook. Please use the hook correctly and carefully to avoid any accidental injury.
- Do not expose a battery pack or appliance to fire or excessive heat. Exposure to fire or temperatures above 130°C/ 265°F may cause an explosion.
- Under normal conditions, users should keep a minimum distance of 20 cm (7.9 in) from the robot.
- The unit must be connected only to a supply circuit that is protected by a ground-fault circuit-interrupter (GFCI). This GFCI should be tested on a routine basis. To test the GFCI, push the test button. The GFCI should interrupt power. Push the reset button. Power should be restored. If the GFCI fails to operate in this manner, the GFCI is defective. If the GFCI interrupts power to the power unit without the test button being pushed, a ground current may be flowing, indicating the possibility of an electric shock. Do not use the power unit. Disconnect the power unit and contact the manufacturer for assistance.
- The robot is equipped with a range of cutting-edge sensors that play a crucial role in its functionality and performance. To ensure the robot's performance and lifespan, avoid placing the robot under extreme environmental conditions for a prolonged period of time, such as high temperatures, intense light, or freezing conditions. It is recommended to use and store the robot within the requirements of this manual.
- Exceeding an altitude of 2100 m (6890 ft) will cause the robotic pool cleaner to be unable to function properly. Therefore, ensure that the robot is used in areas that comply with this altitude restriction to avoid any issues arising from operating the robot at high altitudes.

SAVE THESE INSTRUCTIONS

1.2 FCC/IC Statement

Any changes or modifications not expressly approved by the party responsible for compliance could void the user's authority to operate the equipment. This equipment has been tested and found to comply with the limits for a Class B digital device, under Part 15 of the FCC Rules. These limits are designed to provide adequate protection against harmful interference in a residential installation. This equipment generates, uses, and can radiate radio frequency energy and, if not installed and used in accordance with the instructions, it may cause harmful interference to radio communications. However, there is no guarantee that interference will not occur in a particular installation. If this equipment does cause harmful interference to radio or television reception, which can be determined by turning the equipment off and on, the user is encouraged to try to correct the interference by one or more of the following measures:

- Reorient or relocate the receiving antenna.
- Increase the distance between the equipment and receiver.
- Connect the equipment to an outlet on a circuit different from that to which the receiver is connected.
- Consult the dealer or an experienced radio/TV technician for help.

1.3 MPE Requirements

To satisfy FCC / IC RF exposure requirements, users should maintain a minimum distance of 20 cm (7.9 in) or more between the antenna of this device and persons during device operation. To ensure compliance, operation closer than this distance is not recommended.



Under normal use conditions, this equipment should be kept a separation distance of at least 20 cm (7.9 in) between the antenna and the body of the user.

1.4 5G Statement

Any devices capable of operating in the band 5150-5250 MHz shall only be used indoors to reduce the potential for harmful interference to co-channel mobile satellite systems.

For devices with detachable antenna(s), the maximum antenna gain permitted for devices in the bands 5250-5350 MHz and 5470-5725 MHz shall be such that the equipment still complies with the e.i.r.p. (equivalent isotropically radiated power) limit.

1.5 CEC

First, push the switch to , then push it to , and finally push it to  again and hold for 20 seconds to activate CEC mode.

1.6 Network Security and Data Privacy

Default Network Interface and Service

The following is exposed when the device is in its factory default state:

Network Interface	Network Service	Description
WLAN interface	IoT setup service via TCP port 6668/9998	The transmitted data is used for robot network setup

Recommended Security Practice

To help protect your robot from Denial-of-Service (DoS) attacks, configure the security settings on your home router. Since the robot connects through the router, it will benefit from the router's protection.

Personal Data Management

You can contact us to request the deletion of your device or associated personal data from your account through multiple channels:

- Via the App: Use the built-in support or account settings.
- Via our Official Website: Visit the support or privacy section.
- Via Email: Send your request to privacy@beatbot.com.

1.7 Sensor Description

Sensor	Description
Ultrasonic Sensor	It employs directional transmission of ultrasonic wave and echo analysis to roughly differentiate object types while measuring the distance of surrounding objects. Model: AW-UD1000DC02-2S5, Specification: Test distance: 60~2000 mm (2.4~78.7 in)

02/ Product Introduction

2.1 What's in the Box

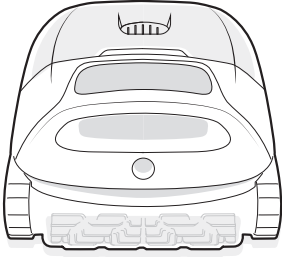

Robot

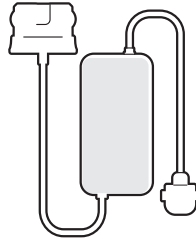

Charger



Hook

2.2 Structure Diagram

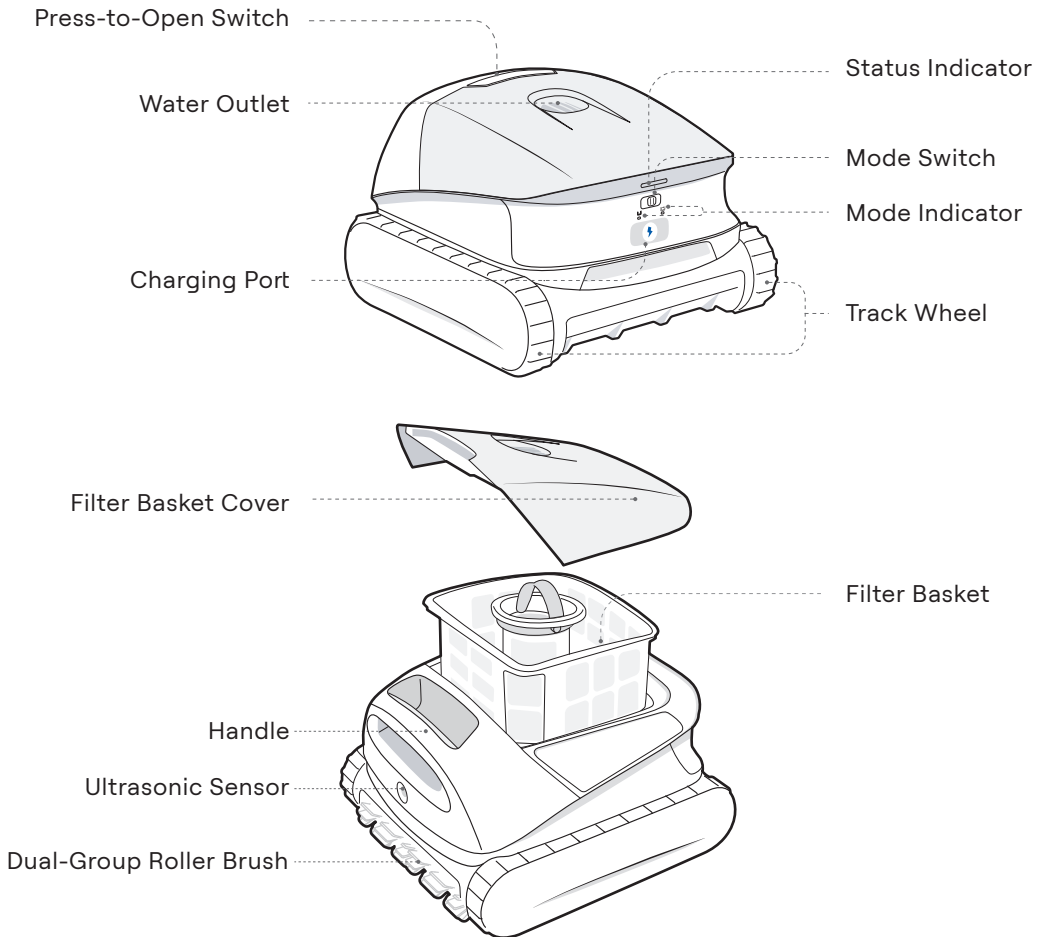

*The diagram is for reference only. Please refer to the actual product for accuracy.

03/ Specifications

3.1 Basic Information

Model	RCMPM031G
Working Voltage	21.6 V
Run Time	5 h
Charger Input	100-240 V ~ 50/60 Hz, 1.8 A Max
Charger Output	28 V \equiv 2.3 A, 64.4 W
Nominal Battery Capacity	7800 mAh
Charging Time	4.5 h
Filter Basket Capacity	5 L
Charging Environment Temperature	0 °C~40 °C (32 °F~104 °F)
Storage Temperature & Humidity	-20 °C~45 °C (-4 °F~113 °F) RH<=75 %
IP Rating	IP68

3.2 Wireless Technology Specifications







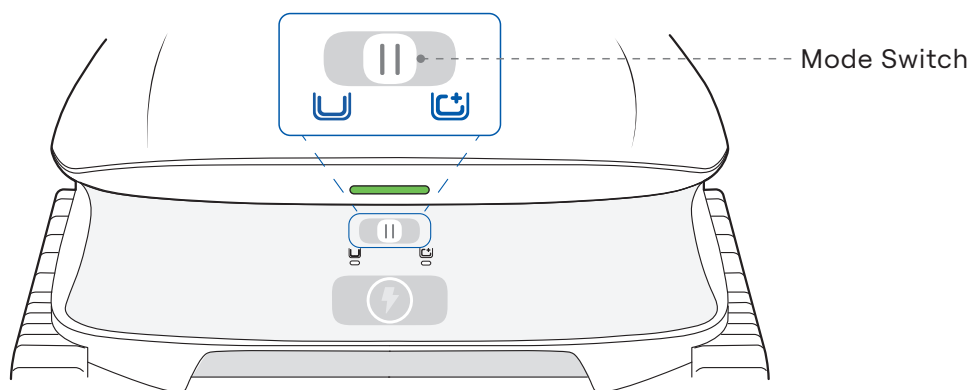

	Operating Frequency	Transmitter Power (EIRP)
Wi-Fi	2.4G: 2.400-2.4835 GHz	2.4G: ≤ 20 dBm
	5G: 5.150-5.350 GHz 5.470-5.725 GHz	5G: ≤ 20 dBm ≤ 27 dBm
	Operating Frequency	Transmitter Power (EIRP)
Bluetooth	2.400-2.4835 GHz	≤ 20 dBm

3.3 Water Conditions for Robot Use

Chlorine	Maximum 4 ppm
NaCl	Maximum 5000 ppm
pH	7.0-7.8 (Recommended)
Water Temperature	6-35 °C (43-95 °F)
Water Depth	0.5-3.5 m (1.6-11.5 ft)





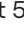

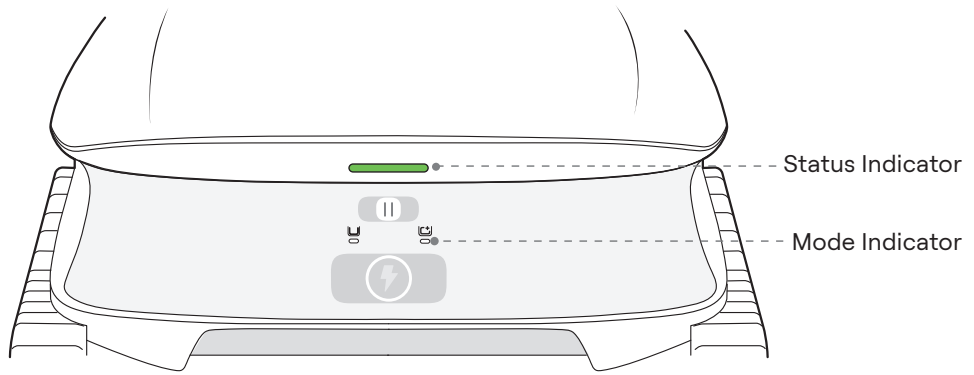
04/ Control and Lights



Operation	How to Operate
Powering On	<p>Push the mode switch to  /  and release it immediately (within 1 second).</p> <p>* The robot powers on automatically when charged.</p>
Powering Off	<p>Push and hold the mode switch on  for about 3 seconds.</p> <p>* If left out of the water and inactive, the robot will automatically power off after 10 minutes.</p>
Selecting Standard Mode	<p>After powering on, push the mode switch to  and release it immediately (within 1 second).</p>
Selecting Preset Mode	<p>After powering on, push the mode switch to  and release it immediately (within 1 second).</p>
Enabling Robot Hotspot	<p>Push and hold the mode switch on  for about 5 seconds.</p>
Factory Resetting	<p>First, push the mode switch to , then push it to  .</p> <p>Finally, push it to  again and hold for about 5 seconds.</p>





Status Indicator

Solid Green Light		Battery Level High
Solid Yellow Light		Battery Level Low
Solid Orange Light		Battery Level Very Low
Flashing Blue Light		Enabling Robot Hotspot / OTA Updating
Flashing Orange Light		Error / Factory Resetting
Breathing Light		Charging

* During the charging process, the light color reflects the current battery level.

Mode Indicator

Solid White Light		Selected Mode
Flashing White Light		Returning

* The indicator for your selected mode will light up in solid white to confirm your selection.

05/ APP

5.1 APP Download

You can either scan the QR code below or search for "Beatbot" in the App Store or Google Play to download the App.



5.2 Robot Connection

Before connecting, please confirm the following:

- The robot is powered on.
- Your phone and the robot are within the same Wi-Fi network coverage and the signal is stable.
- Bring your phone close to the robot.

Once powered on, the robot will automatically enter network setup mode.

Open the Beatbot App. Tap "Add Robot" on the home page, then choose one of the following methods to add your robot and complete the setup:

Add via Bluetooth

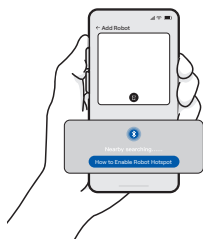

Ensure Bluetooth is enabled on your mobile phone. It will automatically search for your robot model.

OR

Scan to Add

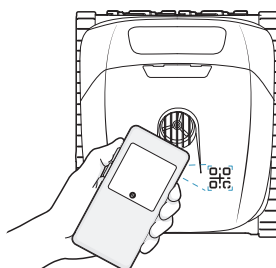

Aim your phone's camera at the QR code located on the robot.

OR

Add Manually

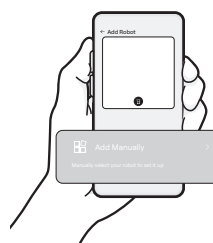

Tap "Add Manually", select your robot model from the list.

Network Setup Failed ?

If you encounter either of the following situations:

1. The initial network setup fails.
2. The robot is already bound to another account.

Please follow these steps:

1. Push and hold the mode switch on  for 5s to enable the robot's hotspot.
2. Follow the instructions in the App to complete the setup process.

06/ Operation

6.1 Start Charging

1. Ensure the charging contacts on the both sides of charger are dry and clean. Align and connect the charger to the robot's charging port.

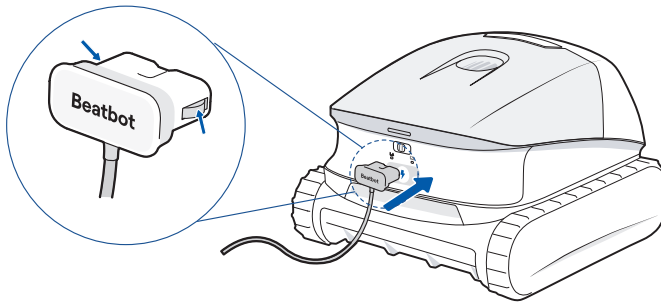

! Caution: Please make sure the charger is fully and securely inserted into the robot.

2. Plug the charger into a power outlet. A breathing light indicates charging is in progress. The robot is fully charged when the status indicator turns solid green.

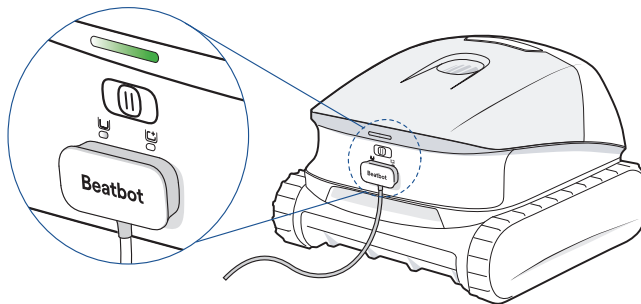

Tips:

1. The robot is partially charged for safety during shipping. A yellow status indicator is normal upon unboxing. Please fully charge the robot before first use for optimal performance.
2. Please charge the robot indoors in a dry, cool place with stable Wi-Fi coverage.

6.2 Prepare Your Pool



Before cleaning, make sure there are no foreign objects such as towels or toys in the pool.





For optimal cleaning results, it's recommended to operate the robot separately from the circulation system.



Avoid animals and people from entering the pool during cleaning.

6.3 Power on & Select Mode

When the robot is off:

Push the mode switch to  /  and release immediately (within 1 second) to power the robot on. The cleaning mode is selected based on the direction you pushed. And the corresponding mode indicator turns solid white.

When the robot is on:

Push the switch to the desired position and release it immediately (within 1 second) to change the cleaning mode.

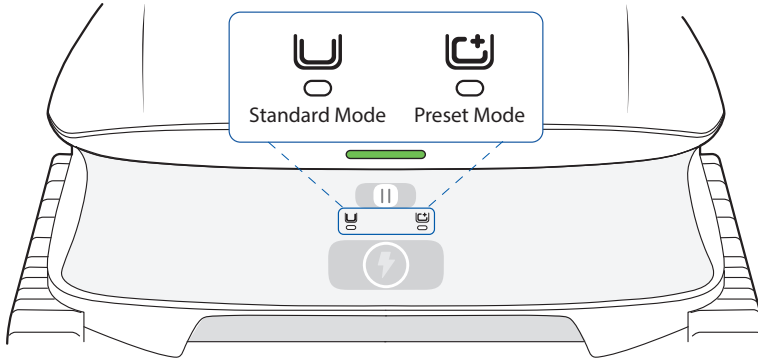

Cleaning Mode	Coverage
Standard Mode	Floor, Walls & Waterline
Preset Mode (Floor Mode defaulted)	Floor

Tip:

You can select other cleaning modes via the App. Your selection will automatically sync to the robot, allowing you to start it directly with the switch next time.

6.4 Start Cleaning

1. Gently place the robot into the water along the pool wall.

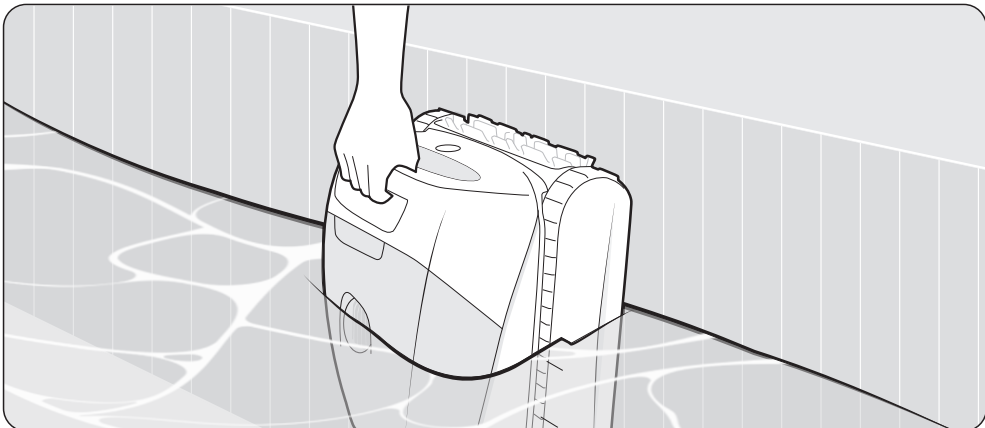

2. The robot begins to submerge and will settle on the pool floor after entering the water. Once settled, it will automatically begin cleaning.

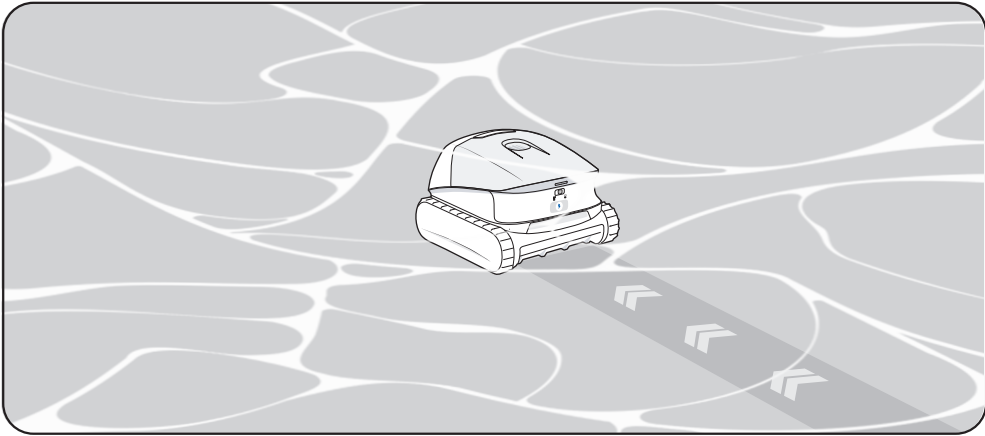

Tip:

Please note that the robot's Wi-Fi signal will weaken and disconnect while it is submerged. This is normal. The connection will automatically restore once the robot exits the water. At that point, the App will reconnect and sync the latest cleaning data.

6.5 Retrieve

1. After completing the cleaning task, the robot will automatically park against the pool wall for 10 minutes, and you can manually retrieve it.

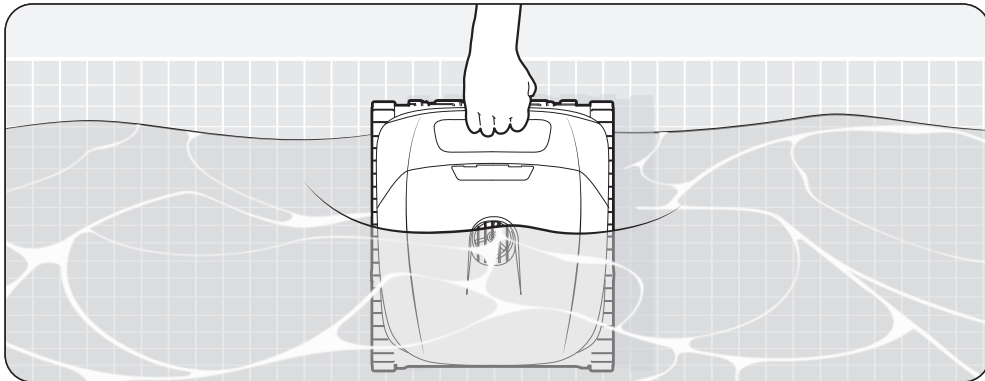

2. In the unlikely event that the robot does not park against the pool wall automatically, or when it submerges to the pool bottom after 10 minutes, you can manually retrieve it using the supplied hook.

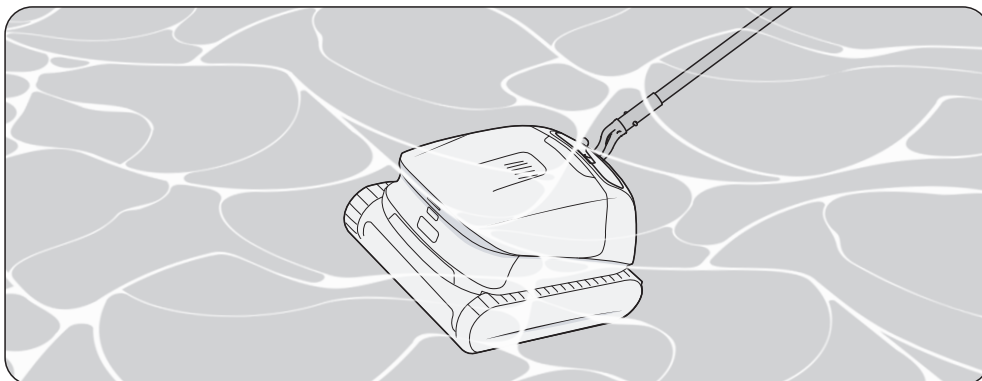

07/ Maintenance

Ensure that the robot is disconnected from the power supply before performing any maintenance. For detailed guides on maintenance procedures and replacement parts, please open the App and navigate to the Maintenance section.

7.1 Filter Basket

- 1 Press the switch to remove the filter basket cover.

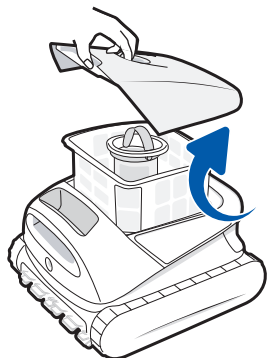

- 2 Take out the filter basket and empty the debris.



- 3 Rinse the filter basket thoroughly with a hose.

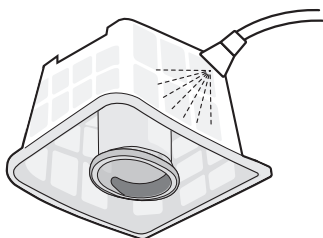

- 4 Reassemble it in the robot, then close the cover.

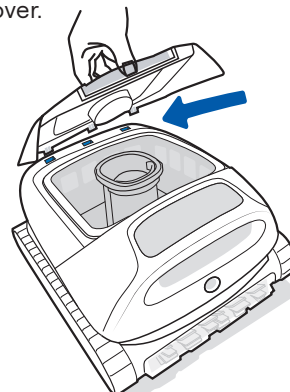

7.2 Roller Brush

- 1 Release the tabs of the roller brush and remove the rubber brush strip.

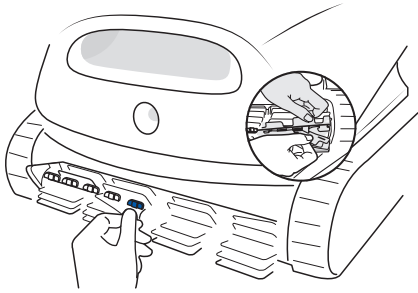

- 2 Clean any debris from the roller brush and rinse it thoroughly with a hose.

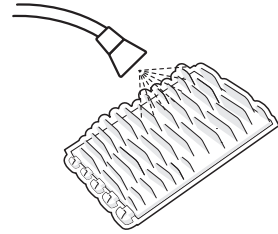

- 3 Reinstall the rubber brush strip into the support.

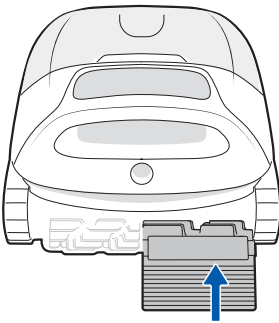

- 4 Thread the tabs through each slot carefully.

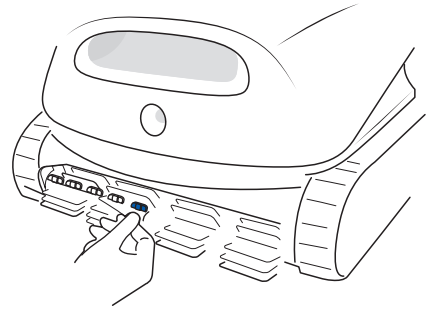

7.3 Ultrasonic Sensor

Ensure no obstructions remain on the sensor after each use. If necessary, gently wipe it with a soft, dry cloth.

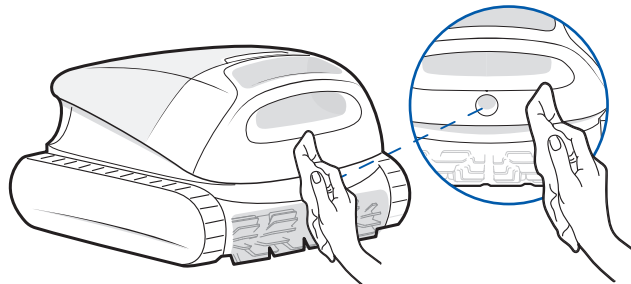

08/ FAQ

Why does the robot stop at the pool floor and not move?

- Check if the robot is in ECO Mode. In this mode, the robot will settle on the pool floor after cleaning and remain there, initiating an automatic cleaning cycle every other day.
- Check if the robot is trapped near the drain or other obstacles. It will attempt to free itself automatically. If, after several minutes, it remains stuck and its status indicator flashes orange, you can help it manually using the supplied hook.
- If the pool is heavily soiled, the filter basket may become clogged rapidly. This can prevent the robot from returning to the poolside. In this case, lift the robot out of the water and clean the filter basket.

Why is the robot offline?

- Weak Wi-Fi signal: The robot may be too far from the Wi-Fi signal range or could have submerged into the water, causing the network to disconnect. The robot will reconnect automatically once the signal is restored.
- Robot shutdown: The robot automatically shuts down when the battery runs out. After charging and powering it on, the robot will reconnect automatically.
- Robot connected by another account: The robot may be connected to another account. You can try to reconnect it through the App's setup process.
- Router related: If the router is rebooting, if there are changes to the router's Wi-Fi name or password, or if the router has blacklisted the robot, please address these issues first to determine if the robot comes back online. If the issue persists, please reconnect.

Why can't the robot be charged?

- Verify that the robot is properly aligned and connected to the charger.
- Check if the charger is fully and securely inserted into the robot.
- Check if the charging contacts on both the robot and the charger are clean and free from rust or debris. If needed, gently clean the contacts before attempting to charge again.

Why is there noise when the robot is powered on ashore?

- This is normal. The robot will intermittently activate the water pump to detect whether it has entered water, producing a slight noise during the process.

Why does the robot automatically shut down after being powered on?

- If the robot is not placed in water for an extended period, it will automatically shut down to conserve battery charge. After powering on, promptly place the robot in water and start the cleaning task.

* If you encounter any issues during usage, please visit the official website/APP to check the FAQ or contact our customer service for help.

09/ Winter Storage

Storage Environment: Find a cool, dry indoor storage space that is shielded from direct sunlight, rain, and frost. Keep the robot away from extreme temperatures, open flames, and places accessible to children.

Dust Protection: Properly protect the robot from dust when stored for a long period of time.

Power Off and Battery Management: Power off and disconnect the robot from the power source when storing. It is recommended to check the battery level at least every 6 months and charge it to around 50%.

10/ After-sales Service

Warranty Period	2-year warranty
Official Website	www.beatbot.com
Support Email	service.eu@beatbot.com
Toll Free	+49 71411424070 Mon-Sun 9:00 -18:00 (CET)

The lithium-ion pack contains substances that are hazardous to the environment. Before disposing of the robot, please remove the battery pack, then discard or recycle it. It is used according to local laws and regulations of the country or region.

11/ WEEE Information

All products bearing this symbol are waste electrical and electronic equipment (WEEE as in directive 2012/19/EU) which should not be mixed with unsorted household waste. Instead, you should protect human health and the environment by handing over your waste equipment to a designated collection point appointed by the government or local authorities for recycling waste electrical and electronic equipment. Correct disposal and recycling will help prevent potential negative consequences to the environment and human health. Please contact the installer or local authorities for more information about the location as well as the terms and conditions of such collection points.